

# DAY ONE 27th February 2015

## Spectator Directions

### SPECTATOR POINT 1. From Scottburgh Country Club to Spectator point 1

#### STAGES 1 & 4 INVERNETTIE

Stage 1 - first car due at 12h50

Stage 4 - first car due at 15h40

- 0.00 Zero your odometer at exit of Country Club & Turn Left into Braam Fischer street
  - 0.15 Turn Left onto R102
  - 1.38 Traffic lights straight on
  - 4.22 Traffic lights, Turn Right at sign post Stevens Road (on left)
  - 31.40 Turn Right onto gravel opposite sign post 'Rosafeld Jerseys'
- S 30° 17.586' E 30° 30.382'**
- 31.99 Keep Right to cane loading zone
  - 32.03 Fork Right into cane loading zone and park here.

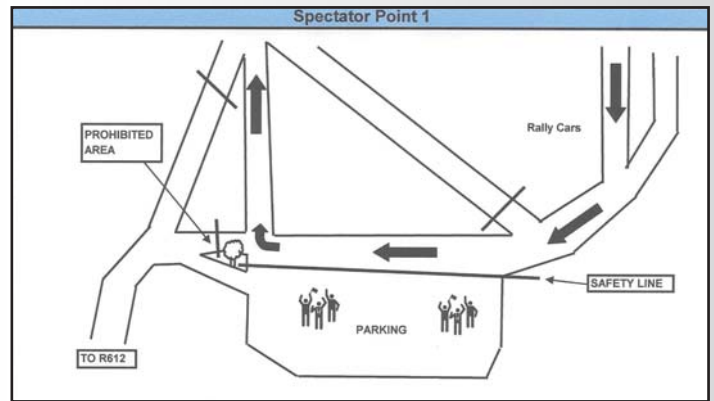

**KEEP CLEAR OF THE RUN-OFF AREA BEFORE THE 90° TURN. THIS IS A PROHIBITED AREA**

Cars can be seen as they come over the hill near the huts on your right. Then they turn right as they pass the spectator point.

### SPECTATOR POINT 2. From Spectator point 1 to Spectator point 2

#### STAGES 2 & 5 DRUMDARROCH

Stage 2 - first car due at 13h15

Stage 5 - first car due at 16h00

- 0.00 Return to the tar road (R612). Zero your odometer & Turn Right
- 3.58 Straight on, past the sign posts 'D307 & SA Police'
- 4.38 Straight on, past the start & end of stages 3 & 6 on the left

**DO NOT TURN INTO THE START OF STAGE, THERE IS NO SPACE TO PARK**

- 6.42 Turn Right into the cane loading zone & park here
- S 30° 16.519' E 30° 27.615'**

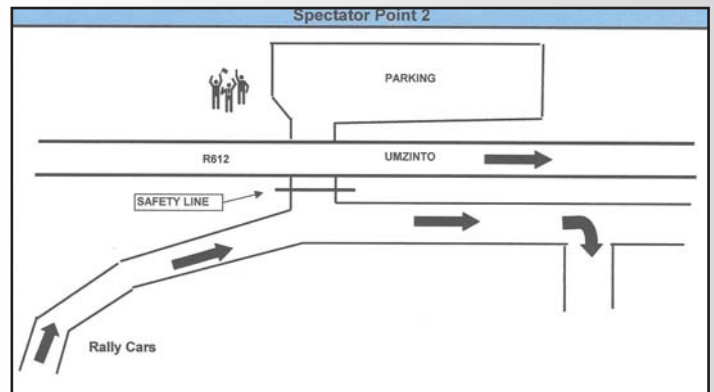

**WARNING! DO NOT PARK OR STAND ON OR NEAR THE MAIN ROAD. KEEP ACCESS ROAD CLEAR AS THIS IS AN EMERGENCY ESCAPE ROAD FROM THE STAGE**

### SPECTATOR POINT 3. From Spectator point 2 to Spectator point 3

#### STAGES 3 & 6 ESPERANZA

Stage 3 - first car due at 13h50

Stage 6 - first car due at 16h45

- 0.00 Return to tar road (R612). Zero odo & Turn Left towards Umzinto.
  - 6.42 Straight on past spectator point 1
  - 24.93 Turn Right at sign post Esperanza / Umzinto North.
  - 25.13 Turn Right onto gravel opposite sign post 'Midlands Auto Supplier'. Keep right up the hill
- S 30° 19.254' E 30° 39.174'**
- 26.60 Turn Left onto soccer field. Park here and walk up to the spectator point
- S 30° 18.993' E 30° 38.369'**

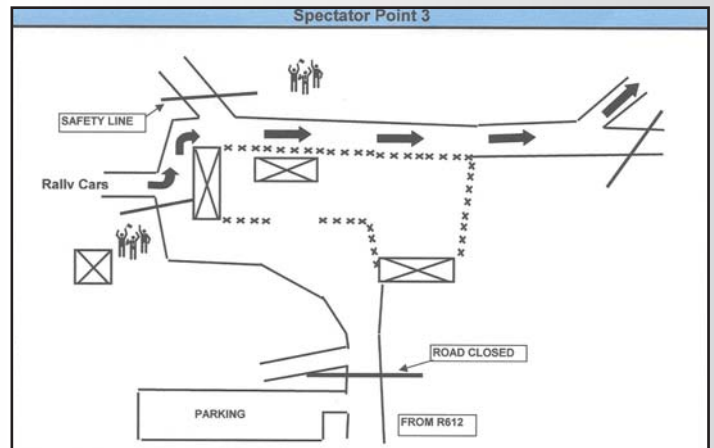

**Cars approach from the left and turn left and right around the back of the building.**

# DAY TWO 28th February 2015

## Spectator Directions

From Scottburgh Country Club to Spectator point 4

### STAGES 7 / 9 & 11 MONTEVIDEO

Stage 7 - first car due at 08h50

Stage 9 - first car due at 10h50

Stage 11 (Power Stage) - first car due at 13h50

- 0.00 Zero your odometer at exit of Country Club & Turn Left into Braam Fischer street
- 0.15 Turn Left onto R102
- 1.38 Traffic lights straight on
- 2.43 Turn Right onto gravel road opposite sign post MONTANA AUDIO (on the building)  
Past the sign post 'LANDERS & SON / MONTEVIDEO'
- S 30° 18.226' E 30° 44.395'**
- 2.45 Park on the soccer field on the right and walk to the spectator point.

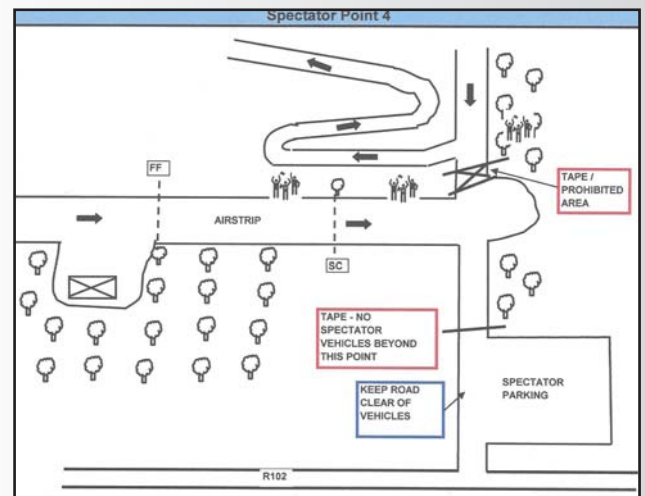

**YOU WILL NOT BE ALLOWED TO PARK IN THE ROAD OR PAST THE TAPE - KEEP THE ROAD CLEAR FOR RALLY TRAFFIC STAND WELL BACK . PLEASE KEEP THE RUN-OFF AREA AT THE END OF THE ROAD CLEAR**

You can make a whole day of the Montevideo Stage. Set yourself up under the trees and watch the cars come through here three times from 08h50 until 15h00.

In between the stages there will be motorcross bikes performing tricks and jumps and New Holland will have a display of earth moving equipment on show. There will be full catering and toilets available.

The final stage of the day will be a Power Stage, where we reverse the field and the slowest cars start first and the rally leaders come at the end. They will be competing for the fastest time in this stage and also the longest jump on the specially made jump in front of you. The quickest cars and longest jumper will wait at the end of the stage until the end when they will be awarded prizes by donated by New Holland.

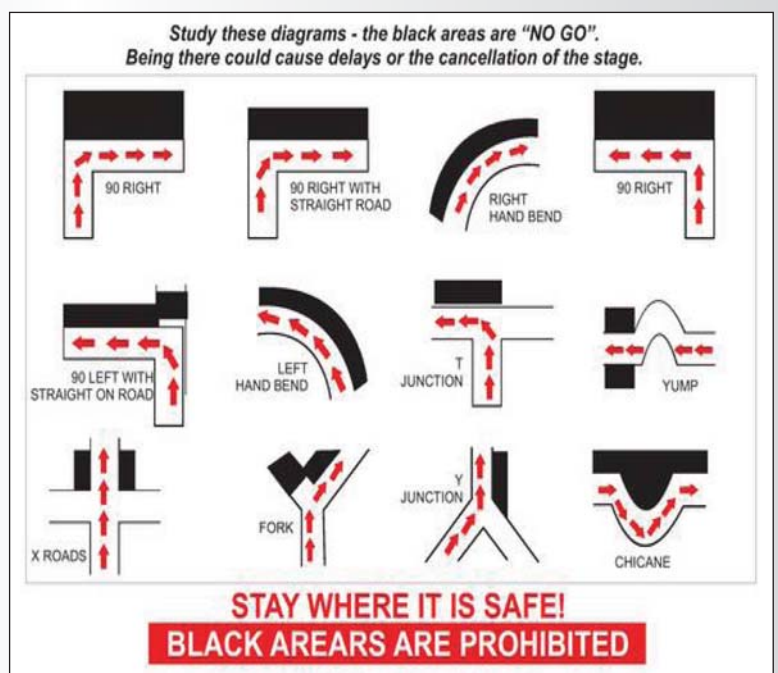

**Warning – Motorsport is dangerous**  
In view of the high speeds attained by the competitors, accidents can happen. The promoters and organizers of this Rally competition cannot guarantee your safety. You are present at your own risk.

## From Spectator point 4 to Spectator points 5 & 6

### STAGES 8 & 10 ELLINGHAM

Choose one of the following two spectator points  
To Ellingham Spectator point 5

#### SPECTATOR POINT 5

Stage 8 - first car due at 09h18  
Stage 10 - first car due at 11h18

- 0.00 Return to the tar road (R102). Zero odo and Turn Right towards Park Rynie
- 1.79 Straight on at traffic lights. Keep on R102
- 3.45 Go straight past spectator point 6 on right
- 5.78 Turn Right onto gravel at sign post 'OSBORNE'
- S 30° 20.992' E 30° 43.144'**
- 5.81 Ignore road to right
- 5.98 Keep right through gate posts
- 6.41 Spectator point 4 is in front of you. Park in the cane loading zone

**S 30° 20.813' E 30° 42.830'**

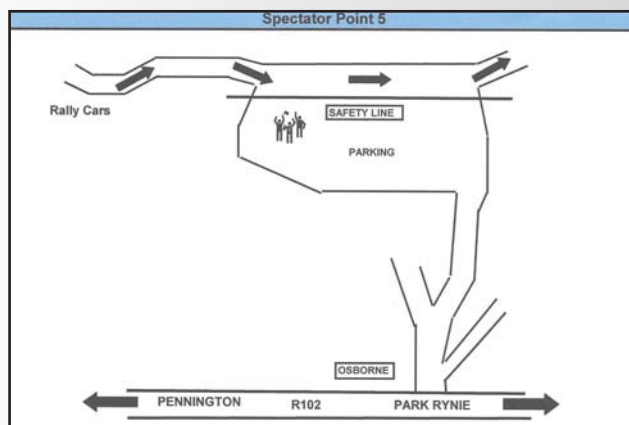

**KEEP ACCESS ROAD CLEAR AS THIS IS AN EMERGENCY ESCAPE ROAD FROM THE STAGE**

Cars approach from the left and through the zone.  
They are visible for 600 metres

#### To Ellingham Spectator point 6

Stage 8 - first car due at 09h22  
Stage 10 - first car due at 11h22

#### SPECTATOR POINT 6

- 0.00 Return to the tar road (R102). Zero odo and Turn Right towards Park Rynie
- 1.79 Straight on at traffic lights. Keep on R102
- 3.45 Spectator point 5 on right at sign post ROCKY BAY RESORTS / CASA BLANCA RESTAURANT  
DO NOT PARK HERE
- S 30° 20.042' E 30 43.874'**
- 3.59 Turn Left to Rocky Bay
- 3.65 Turn Right into loading zone and park, Walk back to the spectator point
- S 30° 20.154' E 30 43.952'**

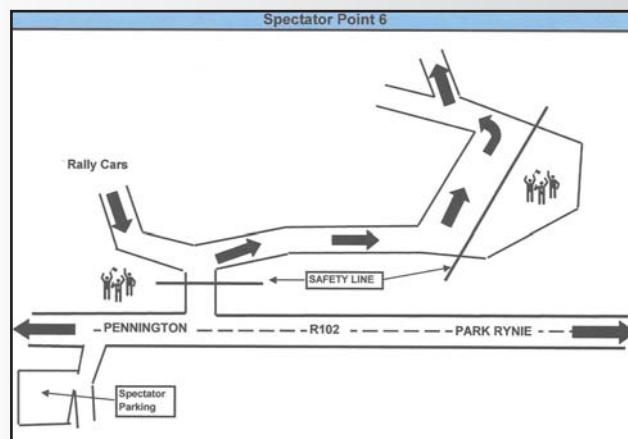

Cars approach from the left and sweep left through the corner.  
You can also walk up the road until you reach a clearing. The cars enter the clearing from the left and do a double left.

**STAND WELL CLEAR AT THIS POINT**



**IMPERIAL**



**TOYOTA**  
YOUR LIFESTYLE DEALER



**npc**  
NATIONAL RALLY CHAMPIONSHIP

Proud sponsors of the Results SMS Service

### Acknowledgements

The organisers extend their sincere thanks to the following organizations and landowners without whom the rally could not be held:-

Invernettie & Drumdarroch	Kinroy Estates -	James & Paul Archibald	Ellingham & Esperanza North
Esperanza South	Finningley Estates -	Sean Crookes	Ellingham Estates -
Monte Video	C.F.Landers & Sons -	Brynn Carbutt	Tim Crookes, Andre Greef, Ronald Cole & Rudi Woortman

